

# Facility Information

Name: Shelly Materials Plant #62

Shipper:

Department:

Site Number: of

State Fees Total:

Report Year: 2019

## ADDRESS

Street Address:

3232 Lancaster Logan Road

Lancaster OH 43130 USA

County: Fairfield Fire District: Cross Street:

Mailing Address:

P.O. Box 266

Thornville OH 43076 USA

Email:

0-1

## PHONES (Type & Phone Number)

No Phone data available.

## CONTACTS

Gatewood, Todd, Plant Superintendent

Phone: Work: 740-687-1610

Dillon, Paul, Operations Manager

Phone: 24-hour: 614.496.0050

Phone: Work: 740.437.2330

Berne Township Fire Dept,

Phone: 24-hour: 740-746-8244

Henry, Thomas, Environmental Representative

Phone: Work: 740.246.1070

Phone: Mobile - Cell: 740.963.2858

## CHEMICAL INVENTORY

8052-42-4 Asphalt Cement

68476-34-6 Diesel Fuel

## CHECKLIST

[x] Submitted general site plan of facility to the state and local emergency planners (Sections 301-303 of ERCRA, 40 CFR sections 300 and 355).

[ ] SDS received with Tier II forms

[ ] All facility info (not including chemical info) is identical to last year's submission

[ ] Are dikes or other safeguard measures employed?

[ ] Site coordinate abbreviations submitted

[x] Chemicals in Inventory records for facility

[ ] EHS Chemicals in Inventory records for facility

[ ] Screening & Scenarios records for facility

[ ] Incident records for facility

[ ] Facility plotted in MARPLOT

Date Tier II Signed: 2/24/2020 Signature: Thomas Henry

Feb 26, 2020

## ID CODES

SIC, 2951, PAVING MIXTURES AND BLOCKS

Air Permit Facility #, 0123000206,

NAICS, 324121, Asphalt Paving Mixture and Block Manufacturing

Dun & Bradstreet, 018343152,

## REGULATORY INFORMATION

## Facility Information

Subject to Emergency Planning under Section 302 of EPCRA (40 CFR part 355)?  Yes  No

Subject to Chem. Accident Prevention under Section 112(r) of CAA (40 CFR part 68, Risk Mgmt. Pgm.)?  Yes  No

Is the facility manned?  Manned  Unmanned      Maximum No. of Occupants: 15

### STATE FIELDS

Ohio requests the following:

Initial Filing (First Time Filer): NO

Updated Filing: NO

Annual Filing: YES

Confidential Location Forms Included: NO

Total EHS Chemicals Included (Not Including Below-threshold Chemicals): 0

Number of Chemicals Included (Not Including Below-threshold Chemicals): 2

Facility name has changed since last Tier II filing: NO

Previous facility name (if known):

Owner/Operator has changed since last Tier II filing: NO

Previous parent company/owner (if known):

### INCIDENTS

No Incident data available.

### MAP DATA

Latitude: 39.678684    Longitude: -82.562702

Record is linked to MARPLOT object

### SCREENING & SCENARIOS

No Screening & Scenarios data available.

### LOCATIONS

Location: T01    Chemical: Asphalt Cement    Amount: 35000 gallons

Type: Above ground tank    Pressure: Ambient pressure    Temperature: Greater than ambient temperature

Location: T02    Chemical: Asphalt Cement    Amount: 10000 gallons

Type: Above ground tank    Pressure: Ambient pressure    Temperature: Greater than ambient temperature

Location: T03    Chemical: Diesel Fuel    Amount: 12000 gallons

Type: Above ground tank    Pressure: Ambient pressure    Temperature: Ambient temperature

### NOTES

No Notes data available.

All Property Lines Greater than 50 feet

State Route 33

Exit 62  
Entrance

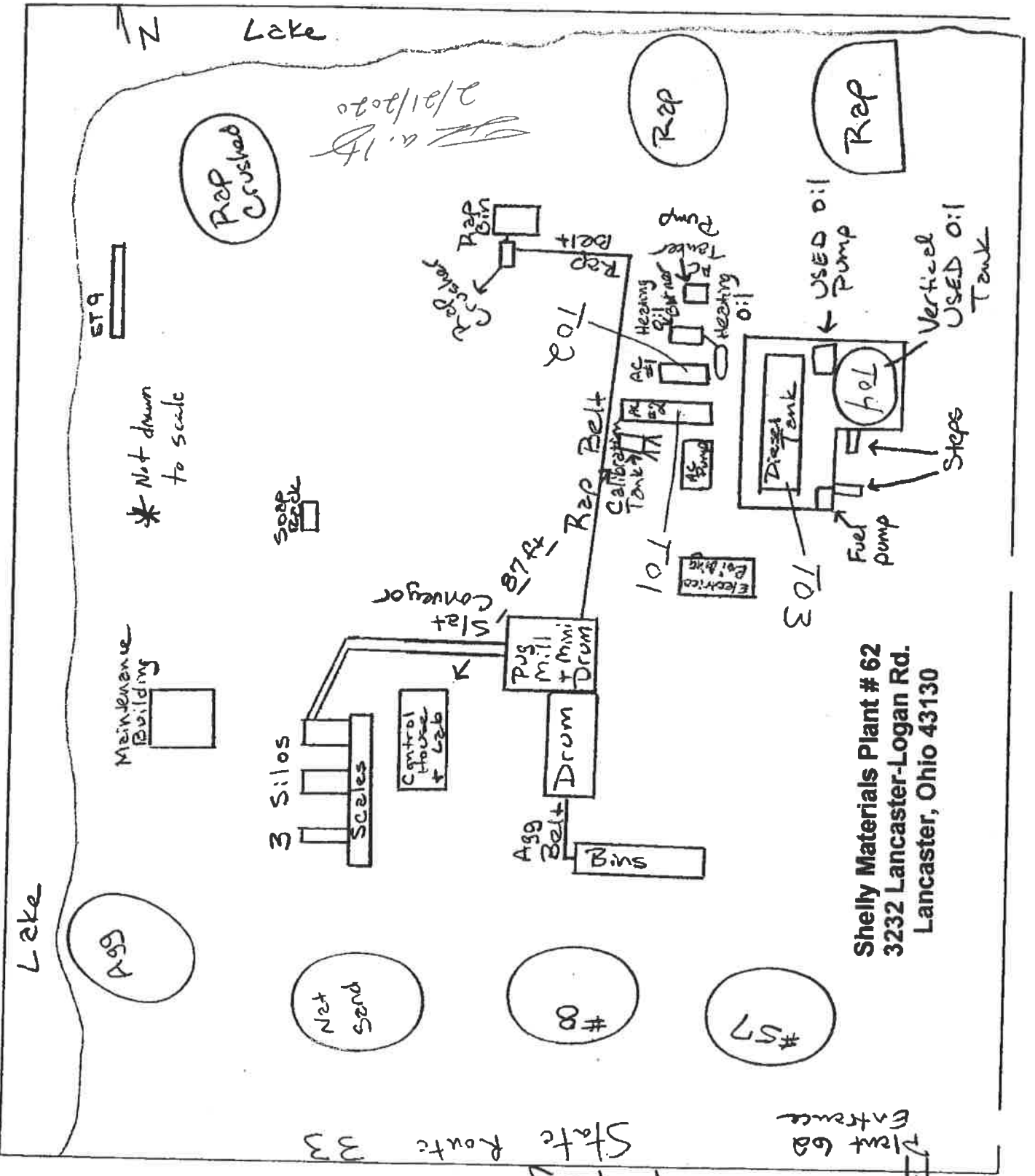

Shelly Materials Plant # 62  
3232 Lancaster-Logan Rd.  
Lancaster, Ohio 43130

\* Not drawn to scale

SOAP

2/21/2020  
[Signature]